

Ceiling Mount for BM / LYD series

DYNAUDIO

INSTALLATION INSTRUCTIONS

- For DYNAUDIO: BM5 mkIII, LYD 5, LYD 7, LYD 8

- Loudspeaker positioning: Angle from 0 - 30° / Direction to the side +/- 45°
- Cables: - ceiling mount suitable for installation underneath an in-ceiling installation box
 - Internal cable routing in the bracket.

The instructions provide directions to all of the important set up and handling steps. We recommend you keep these instructions for future reference.

SAFETY NOTES

- If the product is used at productions and events (professional use) be aware of national regulatory requirements.
- Observe the local mounting regulations (they may deviate from the examples presented here).
- Use 4 screws/anchors for the ceiling mount
- Only use trained technicians to install the system
- Only mount on suitable ceilings with the corresponding assembly materials (not included in the delivery); Example - see Point 2 Observe the placement instructions provided by the anchor manufacturer.
- Ceilings that are too weak or have electrical and water conduits are not suitable. In case of doubt consult a qualified technician.
- Ensure that the screws are tight and load-bearing, in particular as regards the setting of the loudspeaker angle.
- Careful and attentive handling is required when adjusting the stand - due to the possibility of pinching or wedging your hand.
- In case of damage the product may not be used.

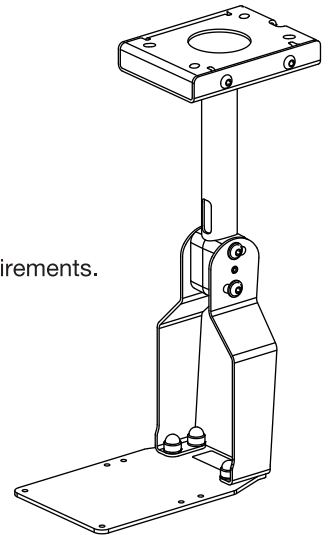

For indoor use only

SET UP INSTRUCTIONS

1 Remove the ceiling plate from the bracket

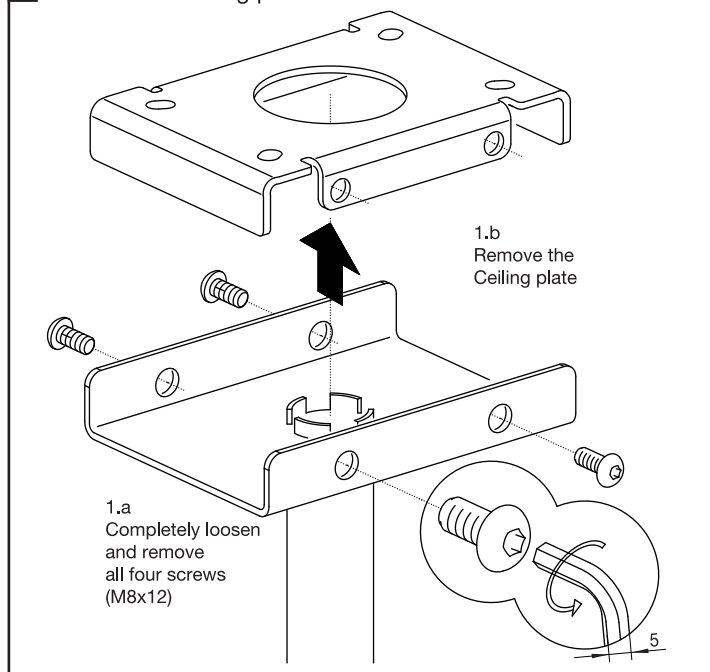

2 Install the Ceiling Plate

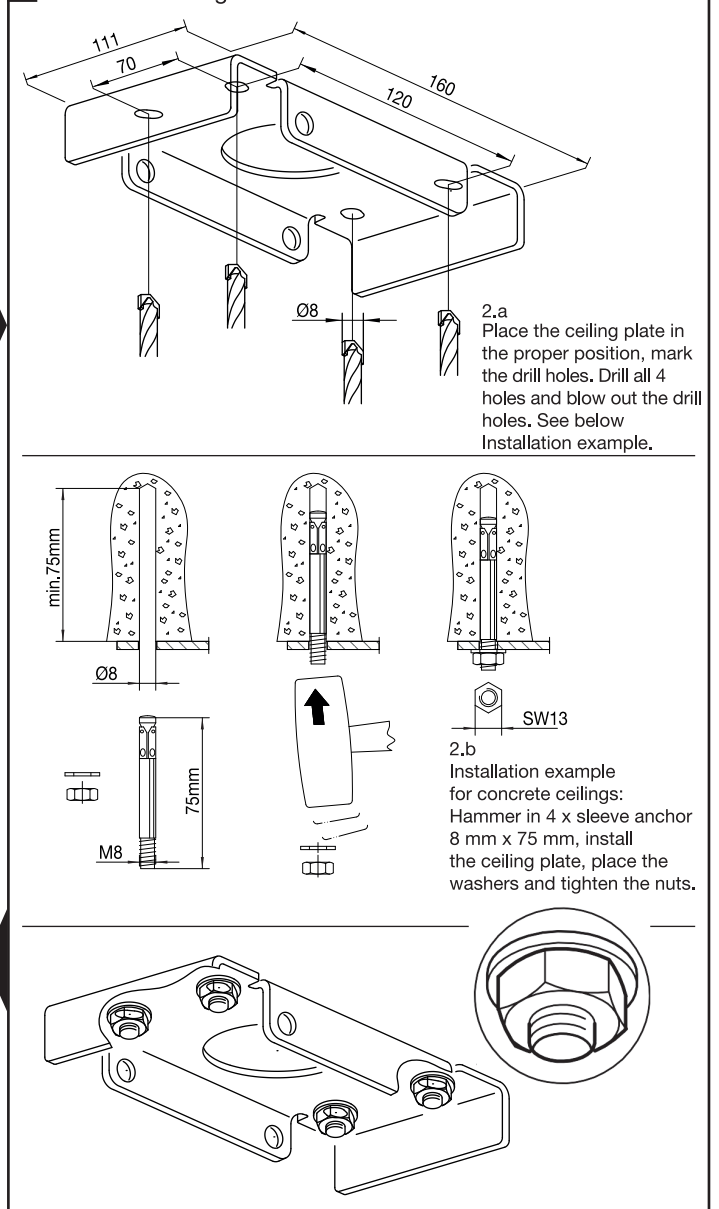

3 Screw the Bracket to the Ceiling Plate

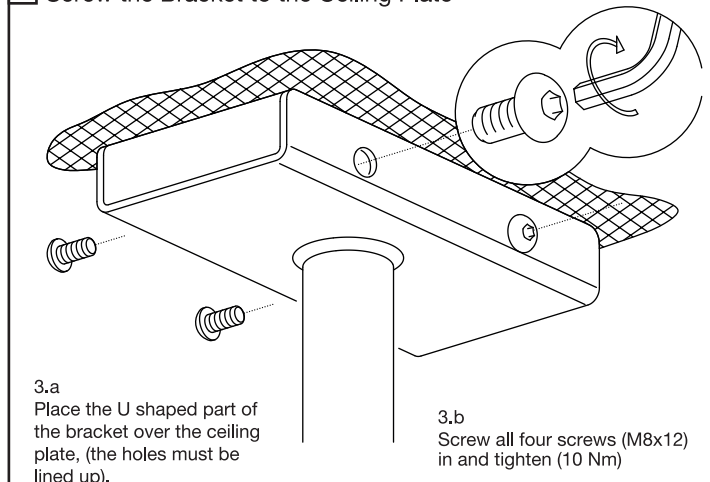

Dynaudio A/S

Sverigesvej 15, DK-8660 Skanderborg, www.dynaudio.com
Item no. 306735 24497-020-55 Rev.01 03-80-888-00 4/20

Ceiling Mount for BM /LYD series

DYNAUDIO

INSTALLATION INSTRUCTIONS

USAGE NOTES

4

Screw the Loudspeaker to the bottom plate

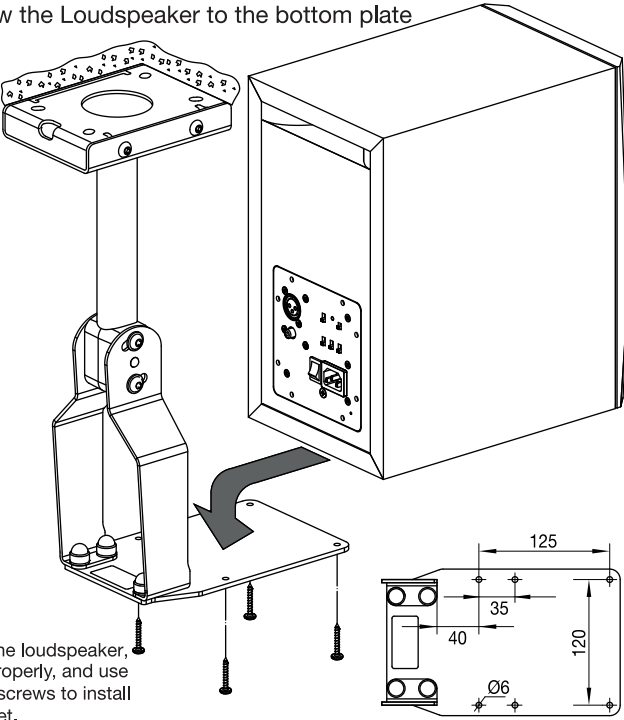

4.a

Prepare the loudspeaker, place it properly, and use the head screws to install the bracket.

5

Cable Guide & Dimensions

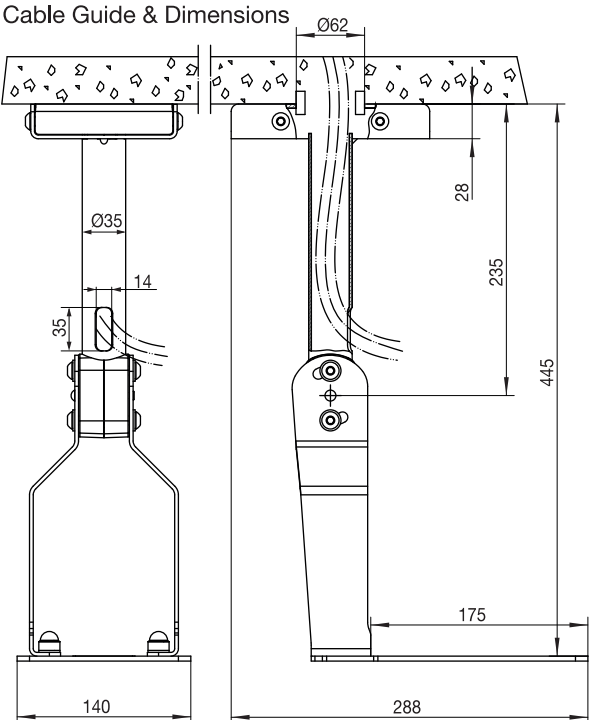

6

Adjustments

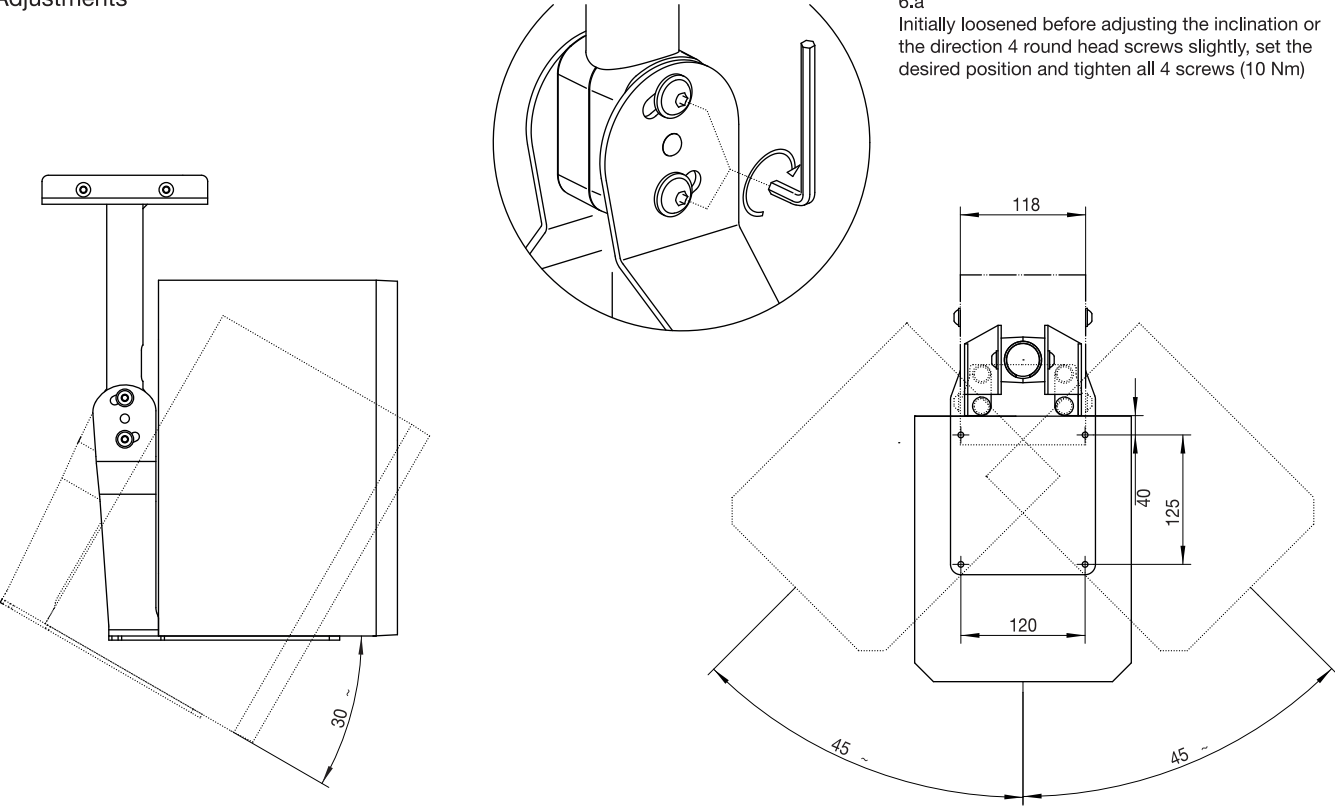

6.a

Initially loosened before adjusting the inclination or the direction 4 round head screws slightly, set the desired position and tighten all 4 screws (10 Nm)

TECHNICAL DATA / SPECIFICATIONS

Material	Bracket, Tube, Support Arms: Steel, powder coating, black Screws: Steel, galvanized Bearing Shells, caps: Plastic (PE, PA)
Load	BM5 mkIII, LYD 5, LYD 7, LYD 8
Dimension	W x D x H: 140 x 449 x 288 mm, Box: 363 x 217 x 497 mm
Weight	net: 3.21 kg., gross: 4.46 kg.
Part number	Ceiling mount: 306735 Installation instructions: 4550832

CHECK, MAINTENANCE, CLEANING

<ul style="list-style-type: none">- In the event of maintenance pay attention to possible risks (wedging, possibility of being knocked into, etc.)- To clean the product use a damp cloth and a non-abrasive cleaning agent.- If the product is used at productions and events the Inspection Regulations in accordance with BGV C1 Sections 33 et seq. apply. (See the supplementary sheet: General Safety)	
FAULT-FINDING (F) and REPAIR (R)	
F: The ceiling mount/bracket is loose	R: Check to ensure the ceiling is suitable (load bearing) (use a qualified technician) R: Check the screws and tighten/replace (use a qualified technician)
F: The loudspeaker is loose	R: Check and re-tighten/replace the screws R: Check the loudspeaker case
F: The loudspeaker inadvertently leans forward	R: Screw connections 6.a screws not properly tightened, i.e. tighten screws