

Wall Mount for BM / LYD series

DYNAUDIO

INSTALLATION INSTRUCTIONS

- For DYNAUDIO: BM5 mkIII, LYD 5, LYD 7, LYD 8

- Loudspeakers positioning: Angle from 0 - 30° / Direction to the side +/- 58°

The instructions provide directions to all of the important set up and handling steps.

We recommend you keep these instructions for future reference.

SAFETY NOTES

- If the product is used at productions and events (professional use) be aware of national regulatory requirements.
- Observe the local mounting regulations (they may deviate from the examples presented here).
- Use 4 screws/anchors for the wall mount
- Only use trained technicians to install the system
- Only mount on suitable structures with the corresponding assembly materials (not included in the delivery); Example - see Point 2 Observe the placement instructions provided by the anchor manufacturer.
- Structures that are too weak or have electrical and water conduits are not suitable. In case of doubt consult a qualified technician.
- Ensure that the screws are tight and load-bearing, in particular as regards the setting of the loudspeaker angle.
- Careful and attentive handling is required when adjusting the stand - due to the possibility of pinching or wedging your hand.
- Only suitable for indoor use.
- In case of damage the product may not be used.

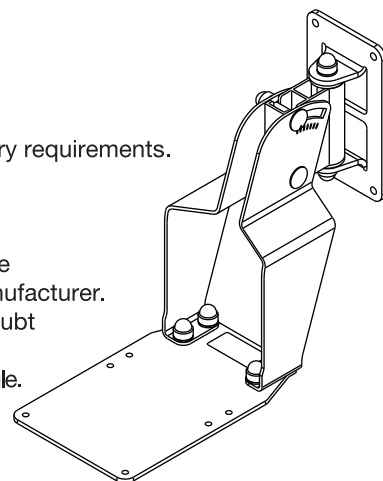

SET UP INSTRUCTIONS

1 Separate the Swivel Support Arm and Wall Mount

1.b Lift up the swivel mount and remove it from the wall mount

1.a Unscrew the lower screws

2 Install the Wall Mount

Hole ø7

2.a Place the holder mount in a vertical position, and mark the drill holes.

2.b Drill the anchor holes (4x)

70

140

3 MOUNT EXAMPLES: **A:** Concrete Wall - Sleeve anchor M6 x 65 mm
Drill, blow out drill holes, hammer in anchors, position wall mount, mount washers, tighten nuts.

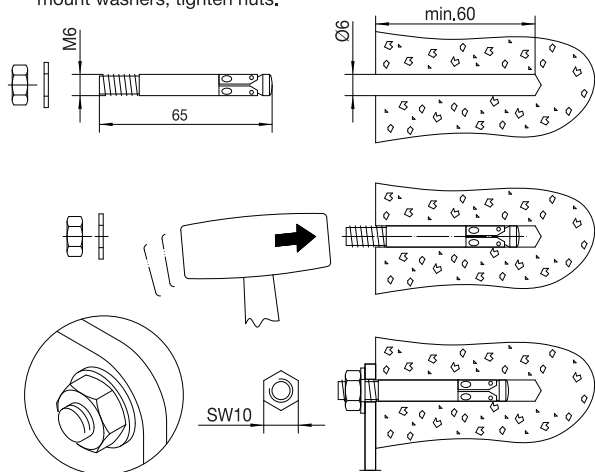

B: Perforated bricks - Frame anchors 8 x 80 mm with wood screw 6 x 85 mm
Drill, counter sink and blow out drill holes, set the anchors, position wall mount screw in screws

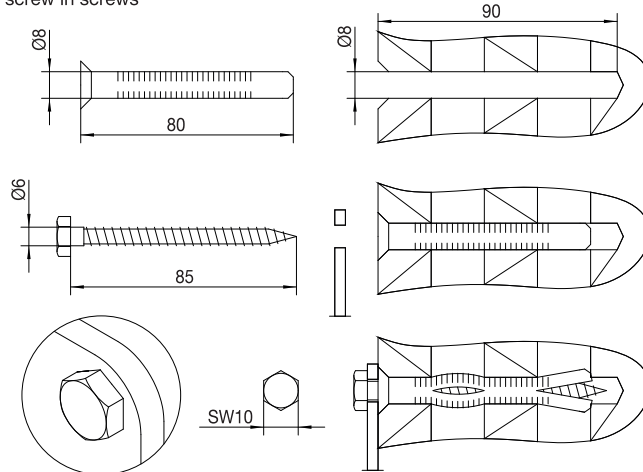

C: Injection molded anchors

- WITHOUT sleeve bushing: for solid masonry and concrete
- WITH sleeve bushing: for hollow bricks

- Advantages: Mount without expansion, as such the mount can be used as often as needed, and enables the mount to be close to the edge (at least 100 mm distance)
- Please follow the assembly/mounting instructions provided with the products.

Dynaudio A/S

Sverigesvej 15, DK-8660 Skanderborg, www.dynaudio.com

Item no. 306730 24498-020-55 Rev.2 03-80-890-00 4/20

Wall Mount for BM / LYD series

DYNAUDIO

INSTALLATION INSTRUCTIONS

USAGE NOTES

4 Screw the loudspeaker to the bottom plate

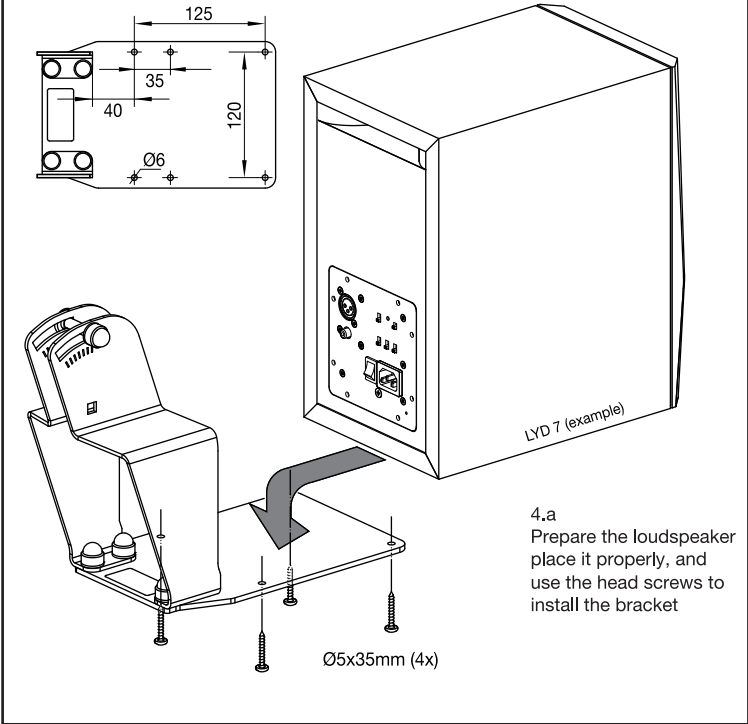

5.1

Swivel Support Arms (with mounted loudspeaker) placed in the wall mount/bracket

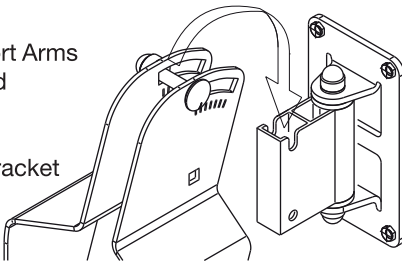

5.2

Secure the Mounted Swivel Support Arms

5.2.a

Place the carriage bolts and washers in the wall mount and swivel supports arms. Tighten the nut, place the cap on the bolt.

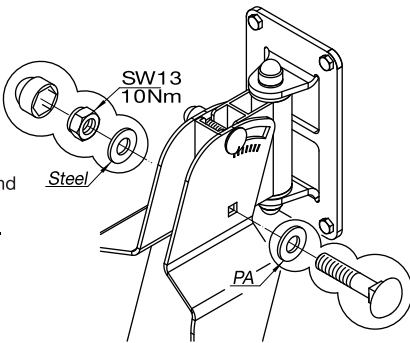

6

6.a Variable adjustment up to 30°. Loosen the upper screw and use the scale to set the angle. Re-tighten the screws.

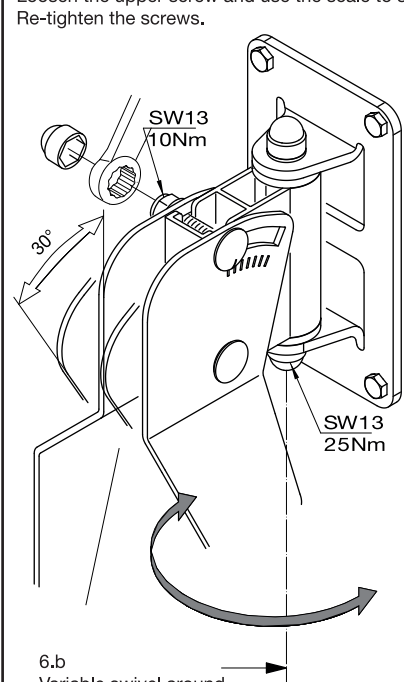

6.b Variable swivel around the vertical axis.

TILTING ANGLE: 0 - 30°

DIRECTION: +/- 58°

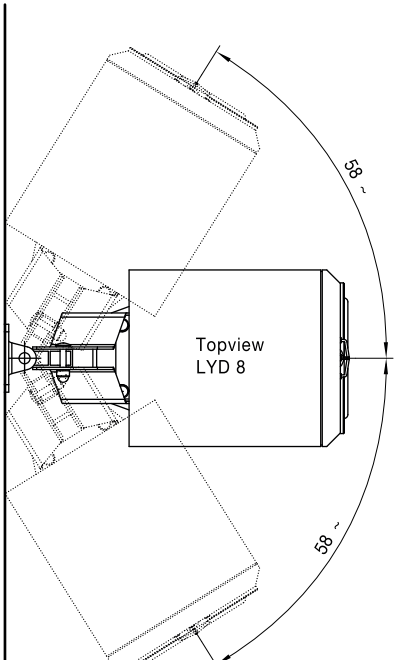
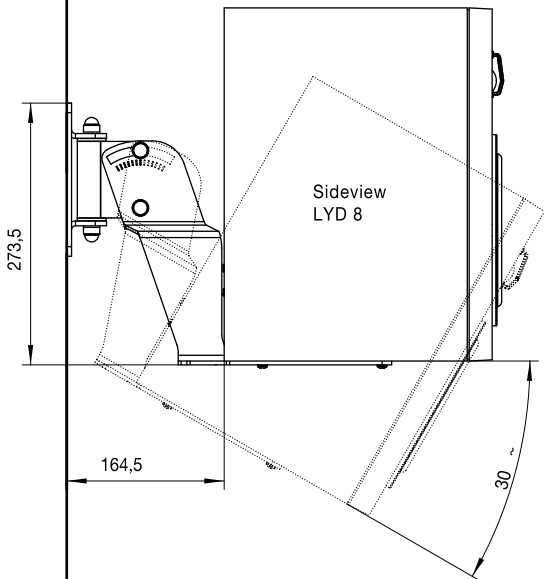

TECHNICAL DATA / SPECIFICATIONS

Material	Bracket, Support Arms: Steel, powder coating, black Suspension profile: Aluminum, powder coating, black Screws: Steel, galvanized Bearing Shells, caps: Plastic (PE, PA)
Load	BM5 mkIII, LYD 5, LYD 7, LYD 8
Dimension	W x D x H: 140 x 340 x 274 mm, Box: 150 x 535 x 230 mm
Weight	net: 2.74 kg gross: 3.12 kg
Load	BM5 mkIII, LYD 5, LYD 7, LYD 8
Part number	Wall mount: 306730 Installation instructions: 4550831

CHECK, MAINTENANCE, CLEANING

- In the event of maintenance pay attention to possible risks (wedging, possibility of being knocked into, etc.)
- To clean the product use a damp cloth and a non-abrasive cleaning agent.
- If the product is used at productions and events the Inspection Regulations in accordance with BGV C1 Sections 33 et seq. apply. (See the supplementary sheet: General Safety)

FAULT-FINDING (F) and REPAIR (R)

- | | |
|--|--|
| F: The ceiling mount/bracket is loose | R: Check to ensure the ceiling is suitable (load bearing) (use a qualified technician) |
| F: The loudspeaker is loose | R: Check the screws and tighten/replace (use a qualified technician) |
| F: The loudspeaker inadvertently leans forward | R: Check and re-tighten/replace the screws |
| | R: Check the loudspeaker case |
| | R: Screw connections 6.a screws not properly tightened, i.e. tighten screws |